

Murrumba Downs

High Physical Support Villa

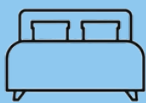

1



Bedroom

1



OOA

1



Bathroom

1



Car

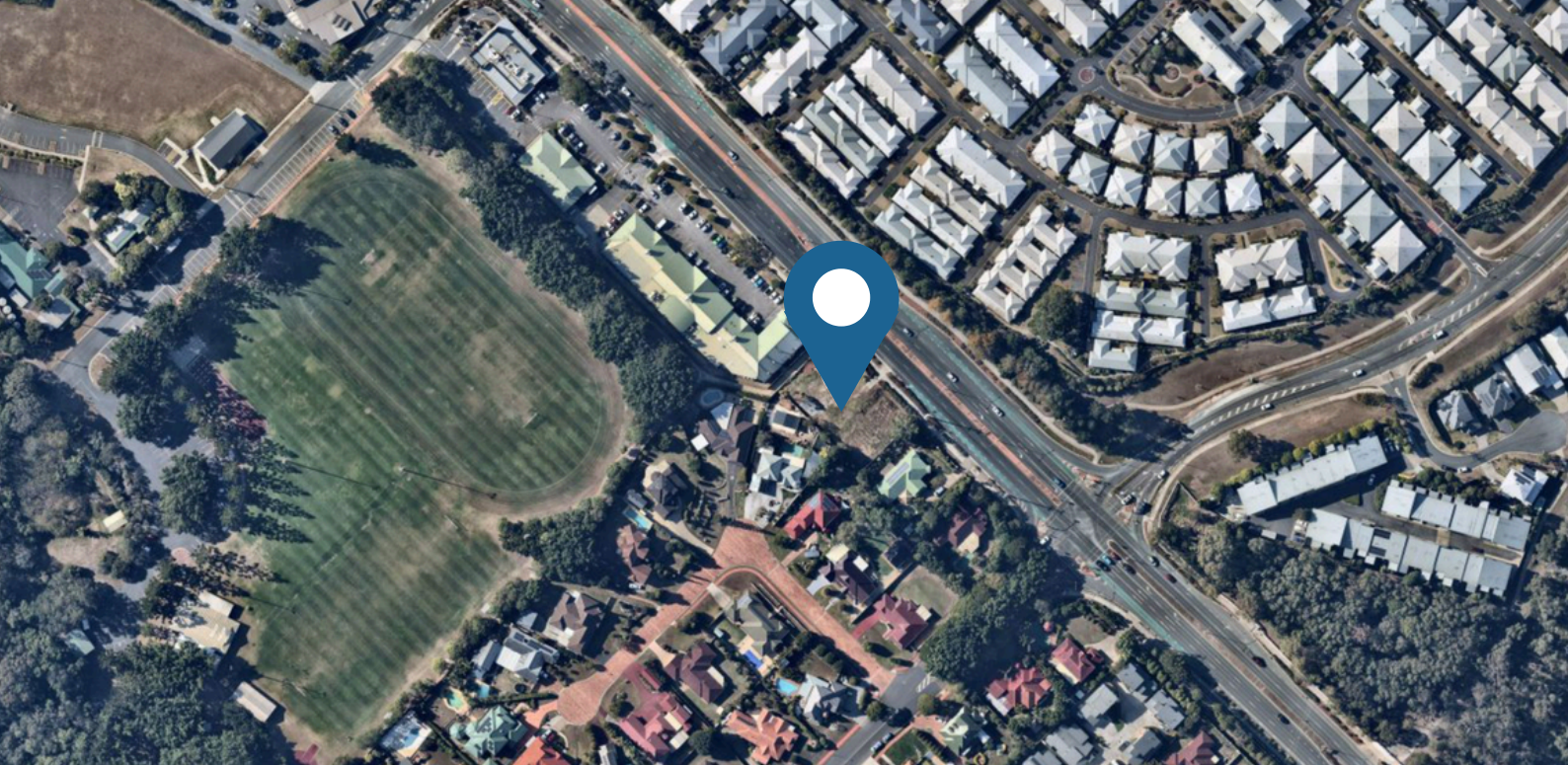

Welcome to your new high physical support haven in Murrumba Downs, close to parks, the water and all the amenities you could possibly need! Just 24km north of Brisbane’s CBD, this delightful residence offers a perfect blend of comfort, convenience and community making it an ideal home for discerning participants.

Live alone in your own space, with our one-bedroom villas plus carers room. Each villa has ample natural light, ensuites for both bedrooms and a open plan kitchen/living room. We even allow pets! As you step out the back you’ll be greeted by Queensland’s sunshine and your own alfresco, perfect for your veggie patch and honing your green thumb. Our High Physical Support home in Murrumba Downs will tick all the boxes!

Rated 4.5 on Homely, residents of Murrumba Downs say it is well connected with the Bruce Highway around the corner and world class shopping and dining precincts at Westfield North Lakes. It has it’s own train station and is friendly and family orientated. Known for its tight-knit community, a range of local events and activities are held each year.

High Physical Support Inclusions

- | | |
|---|--|
| ➔ Heating and cooling to each bedroom | ➔ Structural provisioning in bedrooms for ceiling hoists |
| ➔ Emergency power back up system | ➔ Wifi access points for increased coverage |
| ➔ Custom kitchen cabinetry with knee toe clearances | ➔ Heating and cooling to each bedroom |
| ➔ TV and data points to each bedroom | ➔ Vandal proof door handles |

Local Amenities



Woody Point Jetty
10km >>

Westfield North Lakes
2.64km

Lake Kurwongbah
5km <<

Kallangur Station
1.35km

Ogg Road Park
260m

Murrumba Downs
Shopping Centre 1km

Castle Hill Medical
60m

Moreton Bay

Nestled along the sun-kissed shores of Moreton Bay, Queensland, the Moreton Bay region unfolds as a captivating haven that seamlessly weaves a rich historical narrative into the fabric of modern living. This coastal gem, with its diverse landscape ranging from pristine beaches to hinterland retreats, beckons residents to explore a tapestry of natural wonders unique to this part of the world.

As you wander through the region, the echoes of history come to life. Quaint seaside villages tell tales of early maritime adventures, and heritage-listed landmarks stand as proud guardians of Moreton Bay's cultural heritage. From the iconic Hornibrook Bridge to the charming architecture of Redcliffe's Jetty, every corner reveals a piece of the region's fascinating past.

Culture thrives in Moreton Bay, with local galleries showcasing the works of talented artists and theaters hosting captivating performances. Community festivals, such as the Redcliffe Festival and the Sandgate Arts Trail, bring residents together in celebration of the region's creative spirit. Nature enthusiasts can escape to the wonders of the hinterland or bask in the beauty of Moreton Bay itself, offering a picturesque backdrop for outdoor activities and family picnics.

Dining in Moreton Bay is a culinary odyssey. Fresh seafood straight from the bay, locally sourced produce at bustling markets, and a diverse array of eateries catering to every palate – the region is a food lover's paradise. The sense of community is ingrained in the vibrant events that dot the calendar, from the Redcliffe Jetty Markets to the Woody Point Music Markets, creating a shared experience among residents.

Positioned just north of Brisbane, Moreton Bay provides a coastal lifestyle with urban convenience. The real estate market offers a diverse range of housing options, from waterfront retreats to family-friendly neighborhoods. Educational facilities, including prestigious schools and community-focused programs, add to the region's appeal, making Moreton Bay a haven for families seeking a unique and enriching lifestyle.





Floor Plan

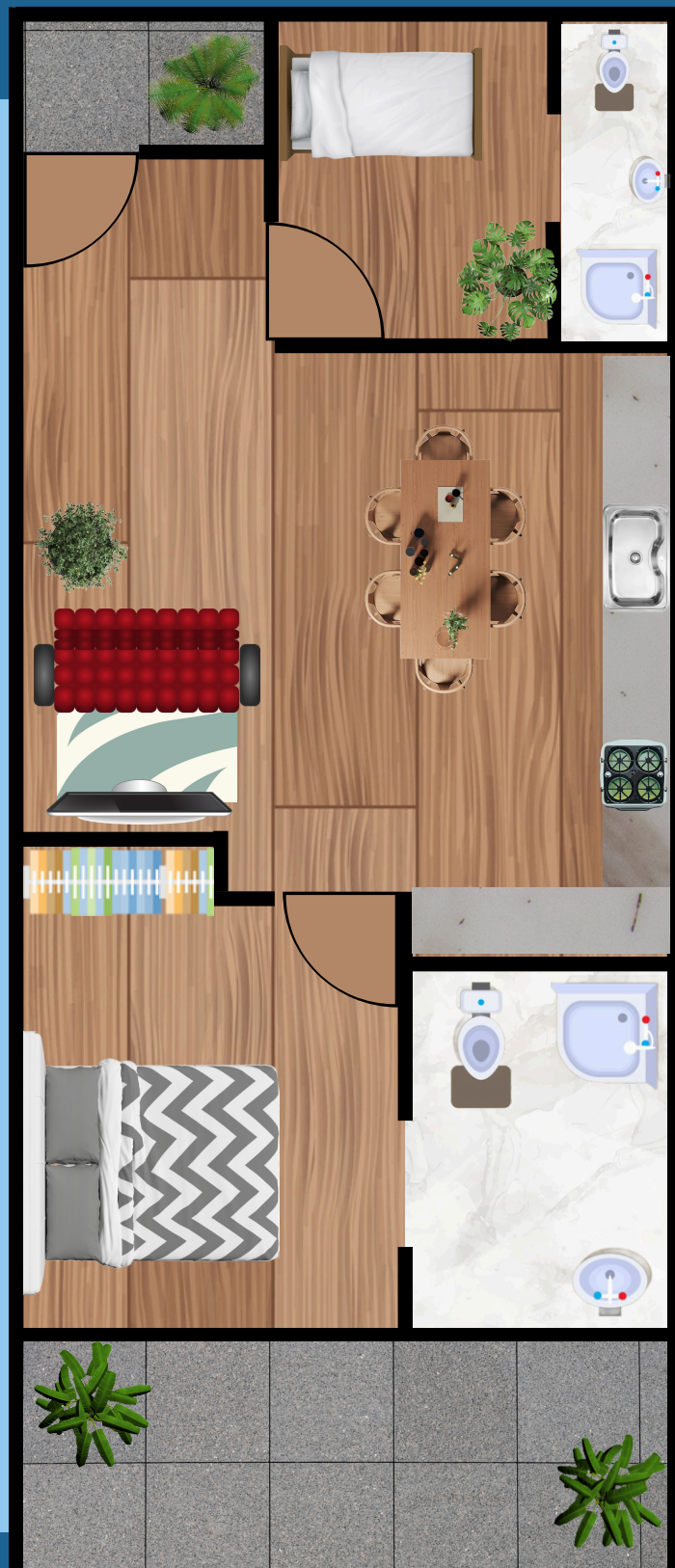

Submit your interest now

1300 869 203

peg@sdaaustraliagroup.com.au



SDA
AUSTRALIA GROUP
ALL HOMES – ALL WAYS